

Franke Tasso Filter Tap

Replacing Cartridges & O Rings

Replacing the cartridge

Before replacing the cartridge you will need to turn the water off. You will first need to remove the handle retaining screw (1) by using a 2.5mm allen key. Once you've removed the handle (2) you can then unscrew the valve cover (3) by unscrewing it anticlockwise. You will then be able to undo the brass screw (4) with a crosshead screwdriver and remove the white plastic sleeve (5) on the valve. You can then remove the existing cartridge (6) by using an adjustable spanner and fit the new parts.

Replacing the o rings

To replace the o rings you will need to remove the spout retaining screw (7) by using a 2.5mm allen key. You can then remove the spout (8) and replace the o rings (9) at the base with the new parts.

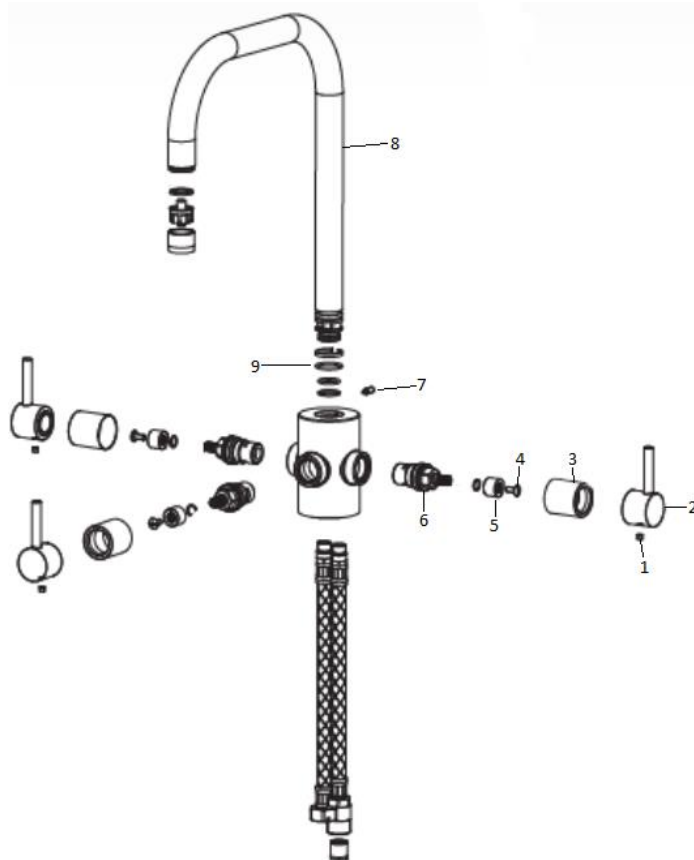

Central Services Ltd
Unit 17 Park Hall Business Village
Park Hall Road
Stoke-on-Trent
ST3 5XA

01782 599258
ks-ukcentralservices.gb@franke.com

*Make
it
Wonderful*

FRANKE